

Operational Manual

English Version

CAR DVD/VCD/CD/MP3 PLAYER

PLD155EL

Contents

Thank you for buying this product.

Please read through these operation instruments so you will know how to operate your model properly. After reading please keep this booklet in safe place for future reference.

1 Before You Start

- Important Safeguards* 4
- About this manual* 4
- Precautions* 5
- Maintenance* 6
- Location & function of the controls* 7
- Remote control* 8
- Specifications* 11

2 Installation

- Wiring Connections* 12
- Installation* 13
- Detach the Unit* 15
- Cleaning the Connector* 18

3 General Operations

- The Starting Animation* 17
- Reset the Unit* 17
- Turning the Unit On/Off* 17
- Volume Control* 17
- Setting the Sound Characteristics* 17
- Turning Loudness On/Off / My Best Position* 18
- EQ Setting* 18
- Displaying and Adjusting Time* 18
- Mute Function* 18
- Display & Adjust Time* 18
- Mode Selector* 18
- Sensor* 18
- AUX In (optional)* 18

4 DVD

- Basic Operation of DVD* 18
- Playing the Previous/Next Track* 19
- Playing the Track FF/F.REW* 18
- Stop the Playback* 18
- Slow Motion Playback* 18
- System Button* 18
- Increase Picture Size* 18
- Repeat Playing* 20
- On Screen Display* 20
- Changing the Viewing Angle* 20
- Changing Audio Language* 21
- Changing the Subtitle Language* 21
- Selecting Different Menu/Title* 21
- Eject a Disc* 21
- Set Up Menu* 21

5 CD/MP3

- Basic Operation of CD/MP3* 28
- Playing the Previous/Next Track* 28
- Playing the Track FF/F.REW* 28
- Repeat Playing* 28
- Playing Tracks at Random* 28
- Stop Playing* 28
- Pause the Playback* 28
- Scanning Tracks Automatically* 28
- ID3 Function* 28
- Eject a Disc* 28
- CD Program Playing* 28
- Mp3 Menu Mode* 30

Simple Troubleshooting Guide

The following checklist is helped to solve the problems which you meet when using the unit. Please double check and make sure if the connection and the procedure of the operation is properly before using the checklist below .

Problem	Cause/Solution
No power.	<ul style="list-style-type: none"> Check and make sure whether the fuse is blown, replace with the proper value if necessary.
Some errors occur in the LCD or no function when pressing the button.	<ul style="list-style-type: none"> Press RESET button.
Unable to receive stations.	<ul style="list-style-type: none"> Check and make sure whether the antenna is inserted or the antenna is properly connected, if so, insert the antenna or connect it properly.
Poor effect on receiving a station.	<ul style="list-style-type: none"> Antenna may not be the proper length. Make sure the antenna is fully extended; if broken, replace the antenna with a new one. The antenna is poorly grounded, check and make sure the antenna is properly grounded at its mounting location. .
CDs cannot be loaded.	<ul style="list-style-type: none"> A CD is loaded in the mechanism.
Sound skips.	<ul style="list-style-type: none"> The CD is dirty or damaged.
No images.	<ul style="list-style-type: none"> The Video line from main unit to the TV is not connected properly.
Images skip.	<ul style="list-style-type: none"> Improper setting of the color system. Set the color system to "PAL" or "NTSC" according to the connected television.

Note:

If any of the problem persist after check list had been made, consult your nearest service dealer. Never attempt to disassemble your unit by yourself.

 **Due to continuous product improvement, the operations are subject to run the model.**

6 VCD

Basic operation of VCD 32
System Button 32
Playing the Previous/Next Track 32
Playing the Track FF/FREW 32
Slow Motion Playback 32
Increase Picture Size 32
On Screen Display 32
Number Buttons 33
Setting Playback Time 33
Repeat Playing 33
Scanning Tracks Automatically 33
Playing Tracks at Random 33
Stop Playing 33
Pause the Playback 34
MO/ST Selector 34
PBC Playing(Menu) 34
Eject a Disc 34
Program Playing 35

7 Tuner

Band Selector 36
Manual/Automatic Tuning 36
Selecting the Stored Station 36
DX/LOC Selector 36
MO/ST Selector 36
Scanning/Memorizing Stations Automatically 37
Number Buttons 37

8 Additional Information

Simple Troubleshooting Guide 38

IMPORTANT SAFEGUARDS

1. **Be sure to connect the color coded leads according to the diagram. Incorrect connections may cause the unit to malfunction or damage the vehicle's electrical system.**
2. **Be sure to connect the speaker (-) leads to the speaker (-) terminal. Never connect the left and right channel speaker cables each other or to the vehicle body.**
3. **Make sure all the connections are completely correct before turning on your unit.**
4. **When replacing the fuse(s), the replacement must be of the same amperage as shown on the fuse holder.**
5. **Do not block vents or radiator panels. Blocking them will cause heat to build up inside and may result in fire.**
6. **After completing the installation and beginning to play the unit(including replacing the battery), please remove the front panel at first, and then press RESET button on the base with pointed object (such as ball-point pen) to set the unit to initial status.**

About this manual

This unit features a number of sophisticated functions ensuring superior operation. All the functions have been designed for the easiest possible use, but many are not self-explanatory. This manual will help you understand the functions and operations of the unit. This manual main explains **remote control operation**. However, in addition to those functions related with DVD/VCD/CD/MP3 operation that can only be operated by the remote control, there are also functions can be operated by the buttons provided for the main unit.

Scanning/Memorizing Stations Automatically

During radio mode, briefly pressing **AMS** button to scan each stored station in cycle.

When press and hold **AMS** button, it will activate automatically memory storing function. The radio automatically selects a station and has it stored in any one of the Number Buttons from 1 to 6.

▣ Notes:

- * Pressing **AMS** and NUMBER BUTTONS button on the head unit perform the same function.

Number Buttons

During radio mode, **Number Buttons from 1 to 6** can help you store your favorite station. You can follow the steps as below:

When receiving a station, press and hold any one of the Number Buttons until "CH" appears in the LCD, which indicates that station is already stored in the corresponding number button.

You can store up to 18 FM stations (6 each for FM1,FM2,FM3),up to 12AM stations (6 each for AM1/MW and AM2/LW).

▣ Note:

- * Pressing **1-6** number buttons on the head unit performs the same function.

Band Selector

During radio status, repeatedly press **BAND** button to select bands in the following order:

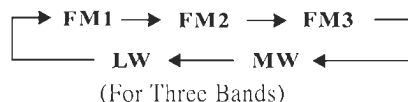
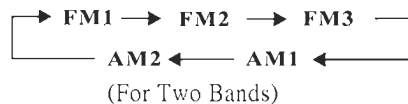

Note:

- * Press and hold **BAND** button to change the FM between USA and Europe.
- * Pressing **BAND** on the head unit performs the same function.

Manual/Automatic Tuning

Manual Tuning: Briefly pressing **6** (▶ or ◀) button on the remote control continuously to select a station downward or upward respectively.

Automatic Tuning: Press and hold **6** (▶ or ◀) button for more than 3 seconds, the radio automatically searches a station downward or upward respectively and plays when it finds a station.

Note:

- * Pressing **6** button on the head unit performs the same function.

Selecting the Stored Station

During radio mode, press **6** ▲ to select the upward stored station, press ▼ to select the downward stored station.

Note:

- * This function is only operated by using remote control.

DX/LOC Selector

During radio status, press **3** **LOC** button on the remote control to select strong or weak station reception.

- 1 It is set to LOC mode when **3** **LOC** button is first pressed. “**LOC**” appears on the display and only local station is available.
- 2 It is switched to DX mode when **3** **LOC** is pressed again. Both distance and local stations can be received.

Note:

- * The initial mode is DX mode.
- * LOC mode is functional only in selecting & memorizing stations.
- * This function is only operated by using remote control.

MO/ST Selector

During radio status, you can press **4** **ST** button on the remote control to select **Mono** mode or **Stereo** mode.

- 1 Stereo reception is charged when “**ST**” and “**STEREO**” appear.
- 2 It is switched to **MONO** mode when “**ST**” and “**STEREO**” disappear.

Note:

- * Pressing **4** **ST** button on the head unit performs the same function.

PRECAUTIONS

This unit can play the following discs only:

Type of disc	Label on the disc	Recorded material	Size of disc
DVD		Sound and moving pictures	12cm
VCD		Sound and moving pictures	12cm
CD		Sound only	12cm
MP3		Sound only	12cm

NOTE: The unit is compatible with VCD1.0/2.0/3.0 version and DVCD disc.

- **Do not attempt to modify the unit, modifying the unit may cause an accident.**
- **Stop the vehicle before carrying out any operation that could interfere with your driving.**
- **Do not work in extremely high or low temperature. Be sure the temperature inside the vehicle is between +60° C and -10° C before turning on your unit .**
- **To enjoy optimum sound and images while playing, handle the discs as follows:**

—Do not use your CDs with paste residue or ink attached.



—Do not use CDs with labels or stickers attached, which may leave a sticky residue while beginning to peel off. (Shown as the picture)



—Clean the discs with an optional cleaning cloth. Wipe each disc from the center out. (Shown as the picture)

—Handle the disc by its edge to keep the disc clean, and do not touch the surface.

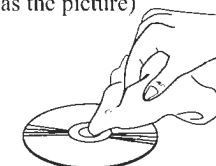

Maintenance

Replacing the Fuse

Make sure the amperage matches the specified value when replacing the fuses. If the fuse is blown, check the power connection and replace with a new one. If the same problem occurs, it would be subjected to the malfunction. In such cases, please consult to the nearest service dealer.

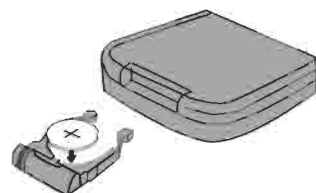

Insert the Battery Holder into the Remote Control.

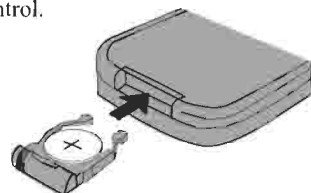

⚠ Warning

Never use the fuse with the rated amperage more than that supplied to your unit, otherwise it will damage the unit.

Replacing the Battery

When the range of the operation of the card remote control becomes short or no functions while operating. Replace the lithium battery with a new button cell (CR2025). Make sure the battery polarity before replace.

Gently pull out the Battery Holder while pressing the Stopper.



Put the button-type battery with mark(+) upward into the Battery Holder.

Precautions on Using Lithium Battery

Always keep the lithium battery beyond children's reach. In case swallowed, see a doctor immediately.

Cleaning the battery with a dry cloth, to ensure its perfect connected.

Make sure the proper polarity when loading with the battery.

To prevent short circuit, do not use metal tweezers to clip the battery.

⚠ Warning!

Improper handle with the battery may lead to explosion. It cannot be charged, disassembled or thrown into a fire.

Program Playing

During VCD mode, you can set the program order to play. Follow the steps as below: when playing a VCD, press **16** button firstly, then press **10** PGM button, the monitor will display:

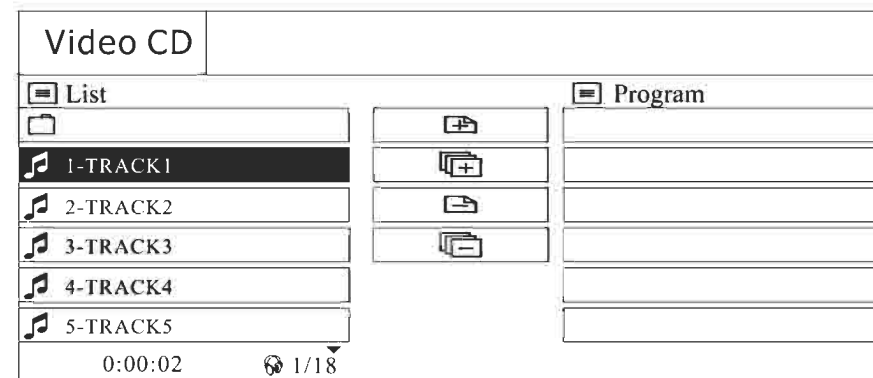

Press **6** button to set the programs you desired, press **6** to remove the icon to , then press ENTER. The tracks you selected appear in the "Program" menu, and press ENTER to play. During programs playing, press **10** PGM button directly to cancel the playing.

Press **6** button to remove the icon to , all the tracks under "List" were transfer to "Program", then press ENTER. The all racks appear in the "Program" menu.

If you want to delete the tracks in "Program" one by one, Press **6** button to remove the icon to .

If you want to delete all tracks in "Program", Press **6** button to remove the icon to .

Note:

* This function is operated by using the remote control.

* Press **22** CLEAR to decrease the large image.

Pause the Playback

During VCD playback, press ⑨ **II** button to suspend the playback. LCD will display: "PAUSE", press it again to return to normal playback,

- ▣ **Note:**
* Pressing **▶||** on the head unit also performs the same operation.

MO/ST Selector

During VCD playing, repeatedly press ④ **AUDIO** button to select **MONO** or **STEREO** mode as below:

Mono left → Stereo → Mono right

- ▣ **Note:**
* This function is operated by using the remote control.

Playing PBC (Menu)

During VCD status, firstly pressing ② **TITLE**, PBC playback starts and **the menu of entire disc** appears on the monitor. And then you can select your favorite track by using **Number Buttons ⑤**. When a track is playing, you can press ⑩ **■** button to return to the menu if you would like to end the track and select others. To cancel PBC playing, press ② **TITLE** button again.

- ▣ **Note:**
* This function is operated by using the remote control.
* **PBC** playing confirms to version 2.0 of SVCD/DVD disc only.

Eject a Disc

Firstly press ② **REL** on the base, then press ⑬ **▲** button to eject a disc.

- ▣ **Notes:**
* This function can only be operated by the head unit.

Location of the Controls

Front Panel

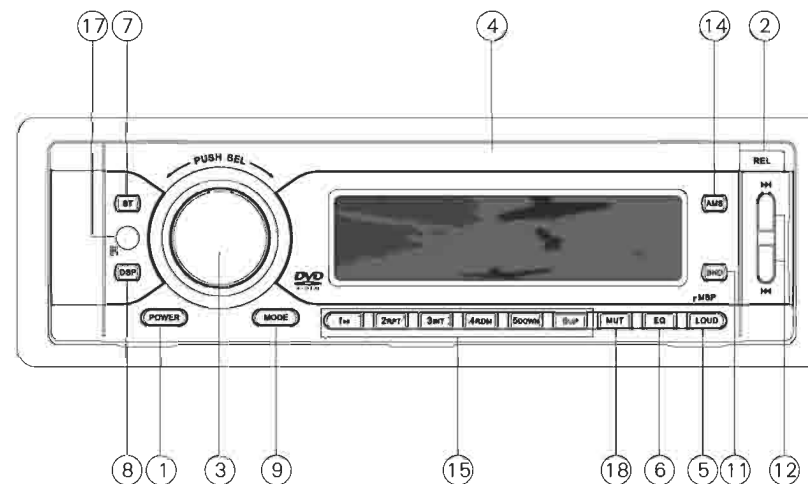

Base

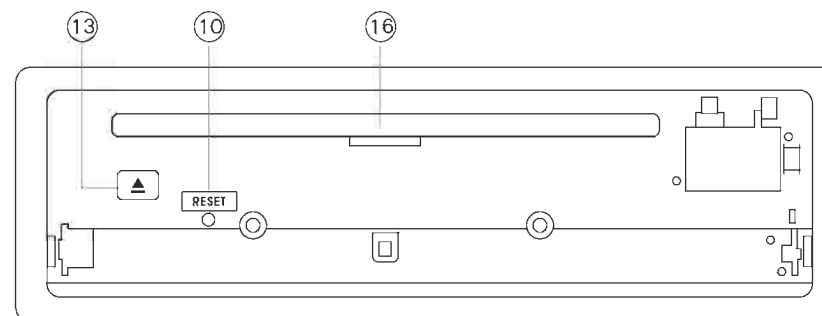

- ① POWER button
Press this button to turn on or off the unit, keep pressing it to turn on the LCD.
- ② RELEASE button
Press REL button to release the front panel.
- ③ VOL/SEL button
Rotate (VOL) button clockwise to increase the volume level; and rotate (VOL) button anticlockwise to decrease the volume level. Press it to set the volume characteristics.
- ④ LCD (LIQUID CRYSTAL DISPLAY)
To display current status.
- ⑤ LOUD/MBP button
shortly pressing it to activate loudness function; keeping press to activate MBP function.
- ⑥ EQ button
Press it to select the corresponding preset modes to adjust the sound quality perfectly.
- ⑦ ST button
During radio mode, press it to select the mono or stereo.
- ⑧ DSP button
Press it to display the current mode.
- ⑨ MODE button
Press to select radio mode or playback mode.
- ⑩ RESET button
Press to set the unit to initial status.
- ⑪ BAND button
During radio mode, press to select among three FM or one AM bands. During Mp3 mode, press it to activate ID3.
- ⑫ ⏮/⏭ Button
Repeatedly press to do manual seek tuning and track search controls.
- ⑬ ▲ EJECT button
Press to eject the disc.
- ⑭ AMS button
During radio mode, shortly press to scan each stored station 5 seconds. Hold and press it to activate automatically storing function.
- ⑮ NUMBER BUTTONS
During radio mode, press for preset tuning; during playback mode, press for activating ▶||, RPT, INT, RDM, DOWN, UP functions.
- ⑯ Disc Loading Slot
- ⑰ Infrared Sensor
- ⑱ MUT button
Press it to mute, press it again to resume to the initial status.

Number Buttons

During VCD status, you can select any track directly by using **5 Number Buttons(0~9)**. For example, if you need the **15th** track, you can firstly press **Button 10+**, and then press **Button 5**, the corresponding track (**15th**) will be played.

▣ Note:

- * This function is operated by using remote control only.
- * The continuously pressing should be within every 3 seconds.

Setting CDs Playback Time

—During VCD status, press **7 GOTO** button to set the time when you begin playing the track, and the television will display the time: **-:--:--**. Enter your desired time by using **5(0~9) Number Buttons**. Then press **6 ▶** to play the track. For example, enter **0:25:00**, it will automatically starts playing the track from the point of twenty-fifth minutes in the disc.

▣ Note:

- * This function is operated by using the remote control.
- * Press **22 CLEAR** to decrease the large image.

Repeat Playing

Press **1 RPT** to perform replaying function when you need to repeat the track you like.

Firstly press **1** button to replay the current track.

Press it again to release single track replaying function.

▣ Note:

- * Pressing **RPT** on the head unit also performs the same operation.
- * The default setting is Disc Repeat.

Scanning Tracks Automatically

During VCD status, press **13 INT** button to play the first 10 seconds of each track on the disc, and the display shows *the track number and the elapsed time*.

Press it once more to revert to normal playing.

▣ Notes:

- * This function can only be operated by the head unit.
- * It is valid in DISC REPEAT mode.

Playing Tracks in Random Order

During VCD status, when pressing **14 RDM** button, “**RDM**” will appear on the monitor, the unit plays any track at random. Press it again to return to the normally playing.

▣ Note:

- * Pressing **RDM** on the head unit also performs the same operation.

Stop the playback

During VCD mode, firstly pressing **16 ■** to pause playing, press **6 ▶** or **9 ||** to play, press **■** button twice to stop playing completely, press **PLAY** button to start playing.

▣ Note:

- * This function is operated by using the remote control.

Basic operation of VCD

Insert a VCD disc into the slot, the unit will automatically switch on, if a VCD disc is loaded, press **2 SOURCE** on the remote control to start the playback.

Note:

* You can eject a disc by pressing **▲** on the base.

System Button

During VCD playback status, press **15 P/N** button to set the TV standard to PAL or NTSC system.

Note:

* This function is operated by using the remote control.

Playing the Previous/Next Track

During VCD playback, firstly pressing **6** **⏮** to replay the current track, press **6** **⏪** within 3 seconds to play the previous track, press **6** **⏩** to play the next track.

Note:

* Pressing **12** button on the head unit also performs the same operation.

Playing Track F.F/F.REW

Press **6** **⏩** or **⏮** to play the track fast forward or fast rewind: each pressing, the change is as following:

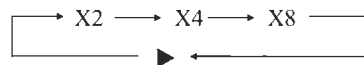

Note:

* Pressing **12** button on the head unit also performs the same operation.

Slow motion playback

During VCD playback, press **8** **⏩** to go slow forward. There are 5 speeds each press decreases the speed until the minimum speed is reached.



Note:

* This function is operated by using the remote control.

Increase the Size of the Picture

During VCD playback, press **17 ZOOM** to increase the picture in size. There are 2 sizes. Each press increases the size until the maximum size is reached.

X400% → X1600% → OFF

Note:

* This function is operated by using the remote control.
 * Pressing **8** to remove the image on the screen.
 * press **22** CLEAR to decrease the large image.

On Screen Display

During VCD status, press **7 OSD** button on the card remote control, the display shows “*single track elapsed time, single track left time, the track being played and the amount of the whole disc*”

Note:

* This function is operated by using the remote control.

Card Remote Control

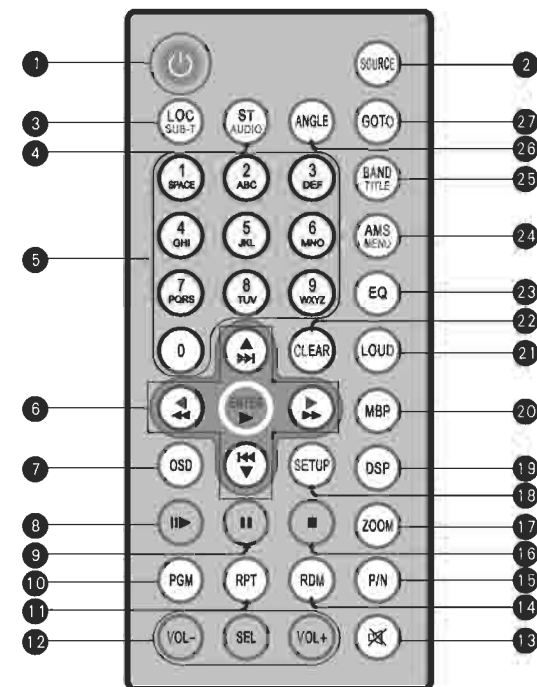

Tips:

For more information as to replacing battery, please refer to “Replacing the Battery” on page 6 .

- | | |
|---|---|
| <p>1 PWR
Press to turn on or off the unit.</p> <p>2 SOURCE
Press to select your desired modes.</p> <p>3 LOC/SUB-T
During radio mode, press it to select the distant or local station; during DVD mode, press it to select the subtitle language.</p> | <p>4 ST/AUDIO
During radio mode, press it to select the mono or stereo channel; during DVD mode, press it to select the audio language.</p> <p>5 (0-9) /A~Z (Number/Letter) Buttons
During radio mode, press 1-6 buttons to select the preset stations; during playback mode, press to select track directly.</p> |
|---|---|

- 6 [▲][▼][◀][▶][ENTER]/[▶][◀][▶] [◀] ([upward][downward][leftward][rightward][enter]/[previous track][next track]/[adjusting the frequency/searching stations/F.F/F.R] Button
- 7 OSD
Press to display title, chapter, the elapsed time, remain time.
- 8 ⏪
During playback mode, press it to slowly forward.
- 9 ⏸
Press it to pause or start the playback. Under the stop status, press it to play.
- 10 PGM
Press it to activate the program playing.
- 11 RPT
During playback mode, press it to start the repeat playing function.
- 12 VOL+/VOL-/SEL
Press VOL+ to increase volume level, and press VOL- to decrease volume level. Repeatedly press to select modes.
- 13  MUTE
Press it to cut down the volume output, press it again to resume volume.
- 14 RDM
During playback mode, press to play tracks at random order.
- 15 P/N
During DVD, VCD status, press it to select PAL or NTSC system.
- 16 ■
Press it to stop playing. When PBC is on, press it to return to the root menu.
- 17 ZOOM
Press to increase or decrease the picture in size.
- 18 SETUP
Press it display the DVD setting menu.
- 19 DSP
Press to display current time.
- 20 MBP
Press it to activate MBP function.
- 21 LOUD
Press it to activate LOUD function.
- 22 CLEAR
During GOTO/PGM/ZOOM status, press it to eradicate mistakes.
- 23 EQ
Press to select the corresponding preset modes to adjust the sound quality.
- 24 AMS/MENU
During radio status, shortly pressing it to scan the each stored station 5 seconds; keep pressing it to activate the AMS function. During VCD/DVD playback, press it to display the root menu of the disc .
- 25 BAND/TITLE/ID3
During radio mode, press to select bands. During DVD status, press it to select different titles. During Mp3 mode, press it to enter ID3 mode.
- 26 ANGLE
Press it to change the viewing angle during DVD playback.
- 27 GOTO
press to set the playback time.

MP3 Menu Mode

* Insert a MP3 disc, the TV screen will display the picture as following :

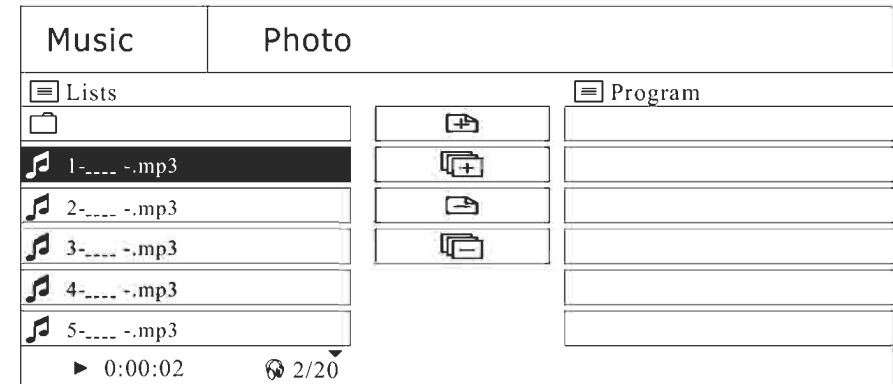

In this picture, the right menu is the left menu's sub-menu, you can press 5 [Number Buttons] to select tracks; or press 6 [▶ / ◀] to select the front or rear track. If you'd like to select director or tracks quickly, please press 16 [■] firstly, then press 6 [▲] [▼] [◀] [▶], and then press 6 [ENTER] button to enter what you do.

When playing a disc including PIC file, press 16 [■] firstly, then press 25 [Title] to enter PHOTO menu, and then press 6 [▲] [▼] button to set up.

Under Mp3 status, press 5/DOWN button to skip to play the previous 10th track of the current track. Such as from the 60th track skip to the 50th track. Press 6/UP button to skip to the next 10th track of the current track; such as from the 60th track to the 70th track.

Program Playing

During CD mode, you can set the program order to play. Follow the steps as below: when playing a CD, press **16** button firstly, then press **10** PGM button, the monitor will display:

Audio CD		Program	
List			
1-TRACK1			
2-TRACK2			
3-TRACK3			
4-TRACK4			
5-TRACK5			
0:00:02	1/18		

Press **6** button to set the programs you desired, press **6** to remove the icon to , then press **ENTER**. The tracks you selected appear in the "Program" menu, and press **ENTER** to play. During programs playing, press **10** PGM button directly to cancel the playing.

Press **6** button to remove the icon to , all the tracks under "List" were transfer to "Program", then press **ENTER**. The all racks appear in the "Program" menu.

If you want to delete the tracks in "Program" one by one, Press **6** button to remove the icon to .

If you want to delete all tracks in "Program", Press **6** button to remove the icon to .

Note:

- * This function is operated by using the remote control.
- * Press **22** CLEAR to decrease the large image.

Specifications

General

Power Requirement	14.4V DC (11-16V allowable)
Load Impedance	4Ω
Max. Power Output	60W X 4
Tone Controls	±10dB Bass 100Hz Treble 10KHz
Dimensions	Approx. 192 x 178 x 50 mm (d/w/h)
Mounting Dimensions	Approx. 169 X 182 X 53 mm (d/w/h)
Weight	Approx. 1.75kg

FM Section

Tuning Range (Optional)	87.5-108(MHz) (Europe) 87.5-107.9(MHz) (U.S.A.) 65-74(MHz) (Russia)
IF Range	10.7MHz
Usable Sensitivity (-30dB)	10dBuV
Signal-to-noise Ratio	60dB
Stereo Separation	30dB (1KHz)
Frequency Response	30-15000Hz

AM Tuner Section

Frequency Range (Optional)	522-1620(KHz) (Europe/Russia) 530-1710(KHz) (U.S.A.)
IF Range	450KHz
Usable Sensitivity (-20dB)	28dBuV

CD Player Section

VCD Signal System	PAL/NTSC
Signal-to-noise Ratio	65dB
Separation	60dB(1KHz)
Distortion	0.1%

DVD Player Section

Number of channel	2 channels
Frequency Response	5Hz to 20,000Hz
Dynamic Range	98dB
Signal-to-Noise Ratio	73dB
Wow and Flutter	Less than measurable limit

Note:

Due to continuous product improvement, specifications and design are subject to change without prior notice.

Wiring Connection

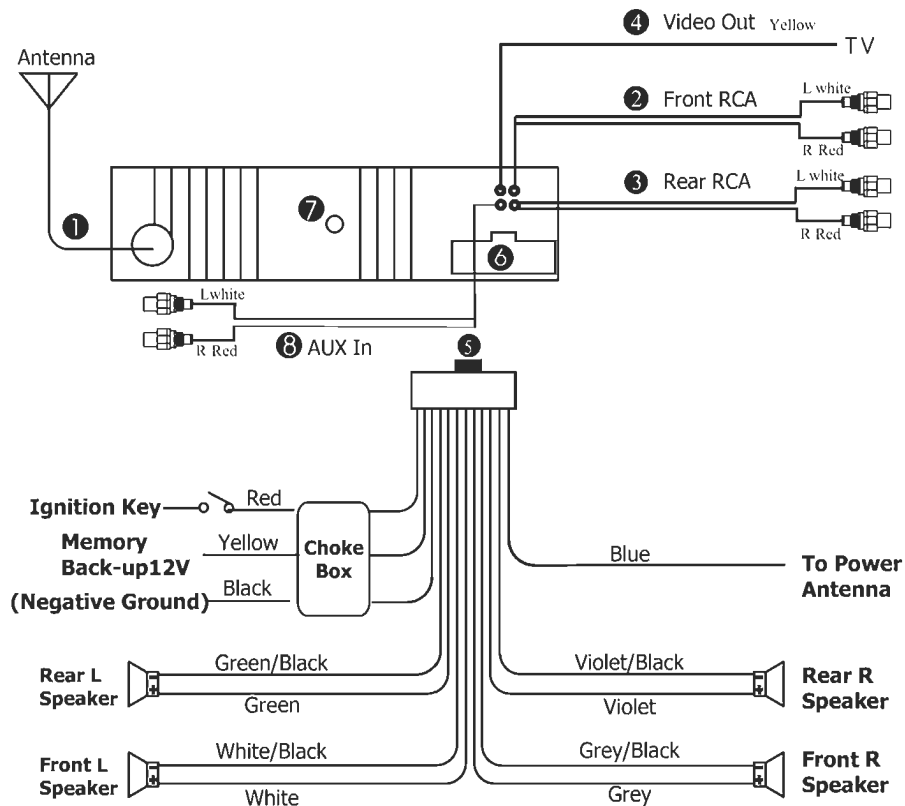

- | | |
|------------------------|--------------------------|
| ① Antenna Receptacle | ⑤ Output Plug (Male) |
| ② Front RCA | ⑥ Output Socket (Female) |
| ③ Rear RCA | ⑦ Screw Holes |
| ④ Video Out Receptacle | ⑧ AUX In (optional) |

Pause the Playback

During CD/MP3 playback, press **⏸** button to suspend the playback, and the LCD shows: **"PAUSE"**. Press it again to return to normal playback.

▣ Note:

- * Pressing **▶||** on the head unit also performs the same operation.

Scanning Tracks Automatically

During CD status, press **⏮** **INT** button to play the first 10 seconds of each track on the disc, and the display shows *the track number* and *the elapsed time*.

▣ Notes:

- * This function can only be operated by the head unit.
- * It is valid in DISC REPEAT mode.

ID3 Function

During MP3 status, press **⏮** **ID3** button to switch between **ID3 ON** and **ID3 OFF**. During **ID3 ON** mode, the LCD displays the current moving Mp3 information. During **ID3 OFF** mode, to perform the common Mp3 operation directly.

▣ Notes:

- * Pressing **BAND** on the head unit also performs the same operation.

Eject a Disc

Press **⏮** **EJ** button to eject a disc.

▣ Notes:

- * This function can only be operated by the head unit.

Basic operation of CD/MP3

Insert a CD/MP3 disc into the slot, the unit will automatically switch on, if a MP3 disc is loaded, press **2 SOURCE** on the remote control to start the playback.

Note:

- * You can eject a disc by pressing **▲** on the base.

Playing the Previous/Next Track

During CD/MP3 playback, firstly pressing **6 ▲** to replay the current track, press **6 ▲** within 3 seconds to play the previous track, press **▼** to play the next track.

Note:

- * Pressing **12** button on the head unit also performs the same operation.

Playing Track F.F/F.REW

Press **6 ►►** or **◄◄** to play the track fast forward or fast rewind: each pressing, the change is as following:

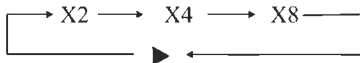

Note:

- * Pressing **12** button on the head unit also performs the same operation.

Repeat Playing

During CD/MP3 playback, press **11 RPT** to perform replaying function when you need to repeat the tracks you like.

Firstly press **11** button to replay the current track. Press it again to cancel this function.

Note:

- * Pressing RPT on the head unit also performs the same operation.
- * The default setting is Disc Repeat.

Playing Tracks in Random Order

During CD/MP3 playback status, when pressing **14 RDM** button on the remote control, "RDM" will appear on the monitor, the unit plays any track at random under the directory which you select. Press **RDM** again to return to normally playing.

Note:

- * Pressing RDM on the head unit also performs the same operation.

Stop the playback

During CD/MP3 mode, firstly pressing **16 ■** to pause playing, press **6 ►** or **9 ||** to play, press **■** button twice to stop playing completely, press **PLAY** button to start playing.

Note:

- * This function is operated by using the remote control.

Install the Front Panel

Put notch **(A)** (Shown as picture) onto shaft **(B)**. And then slightly press into the right side.

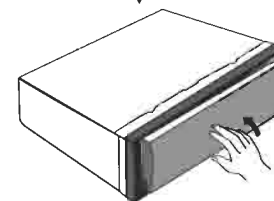
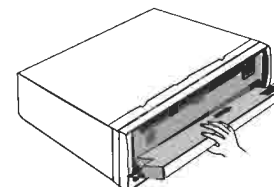
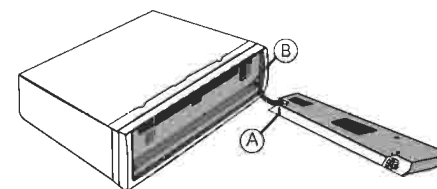

Note:

- * Never put any objects into the front panel.

Press **2 (REL)** button in the upper right corner, and then the front panel will be folded down.

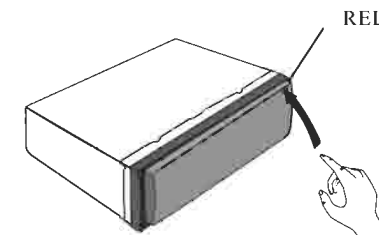

When the front panel was turned down to a position of 45°, hold and slide the front panel to left, and then pull it out.

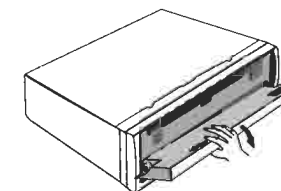

Installation Method ① : DIN Front-Mount

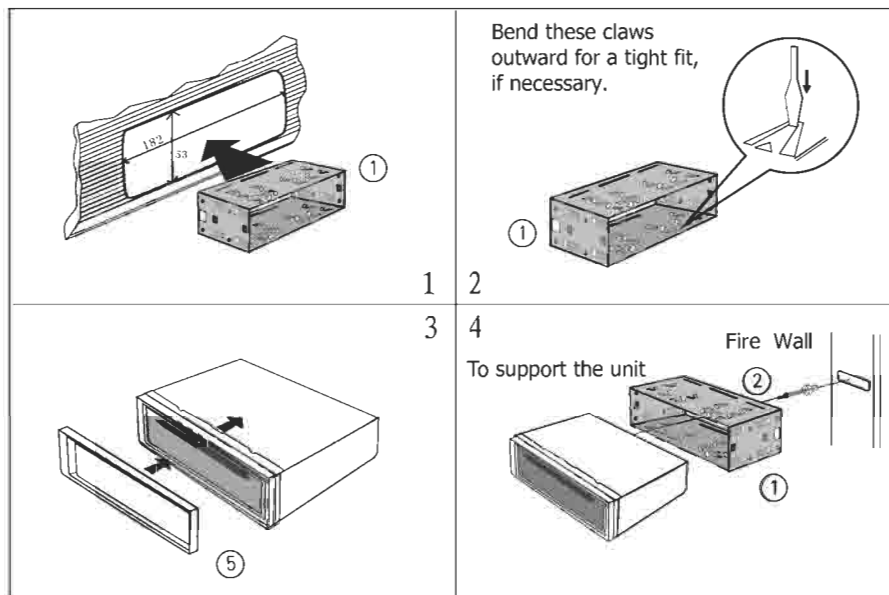

Installation Method ②

Installation using the screw holes at the sides of the unit.

1. Remove the hooks on both sides.
2. Select a position where the screw holes of the mounting bracket supplied with the car and the screw holes of the main unit become aligned (are fitted), and tighten the screws (see ④) at 2 places on each side. And then fasten them to the car.

NOTE:

- * Outer Trim Frame ⑤ Hook ⑨ and Mounting Sleeve ① are not used for installation method ②

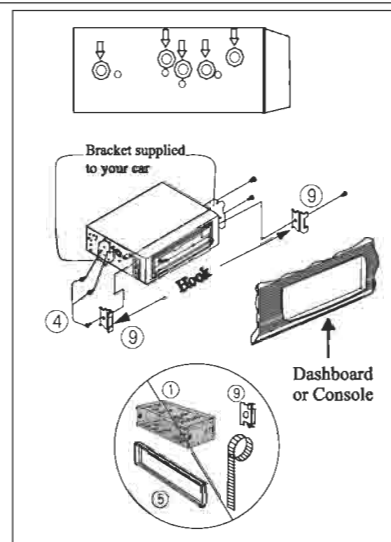

---Others---

[Press ▶]

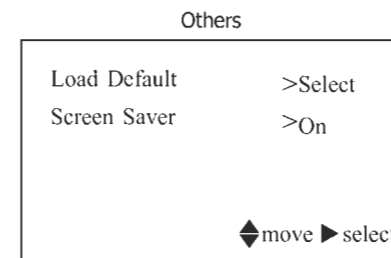

[Press ▼]

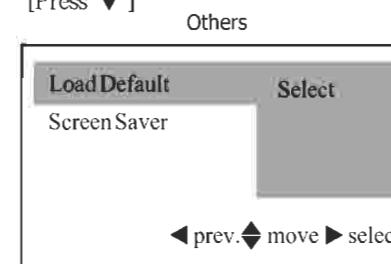

Note: This load default is no function in menu language.



[Press ▼]

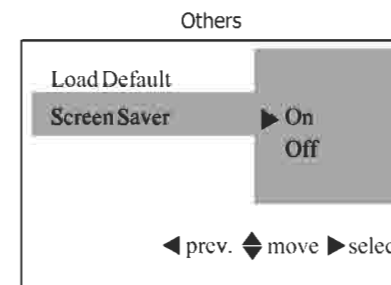

Note: The same operation with language setup.

---Preferences page--

PARENTAL

[Press ▶]

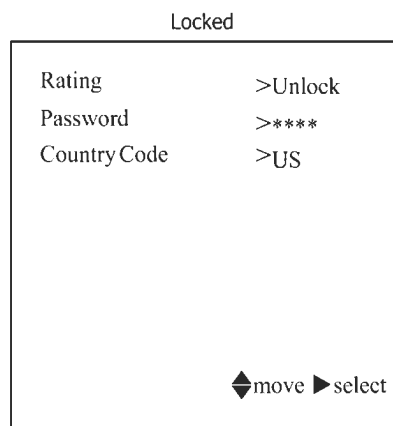

[Press ▼]

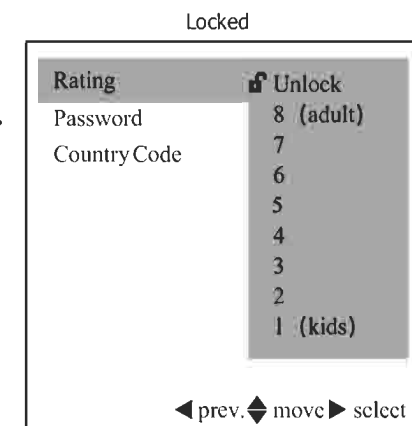

[Press ▼]

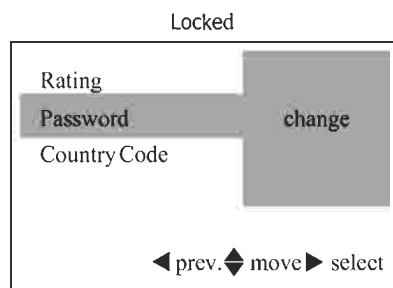

[Press ▼]

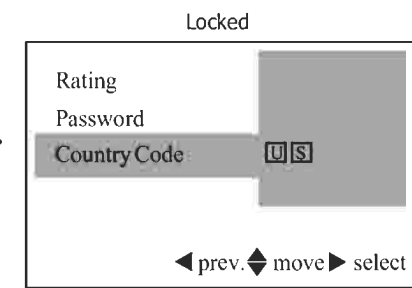

Note:
PASSWORD: The default password is 8888.
If you want to change the password, you
have to input the old one first, then input
the new one.

Note: The same operation with the language setup.

Detach the Unit

Detach the front panel before disassembling the unit. For more details regarding this section, refer to “**Detach the Front Panel**” .

1. Take out the Outer Trim Frame after detaching the front panel.

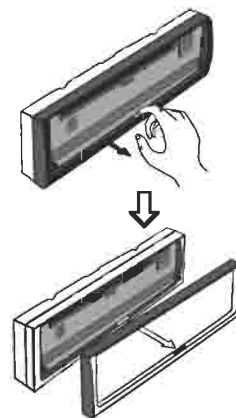

2. Insert the keys supplied to the unit at both sides of the unit (shown as illustrated) until they click. Pulling the keys makes it possible to remove the unit from the dashboard.

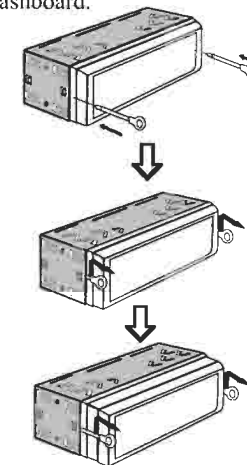

Parts List

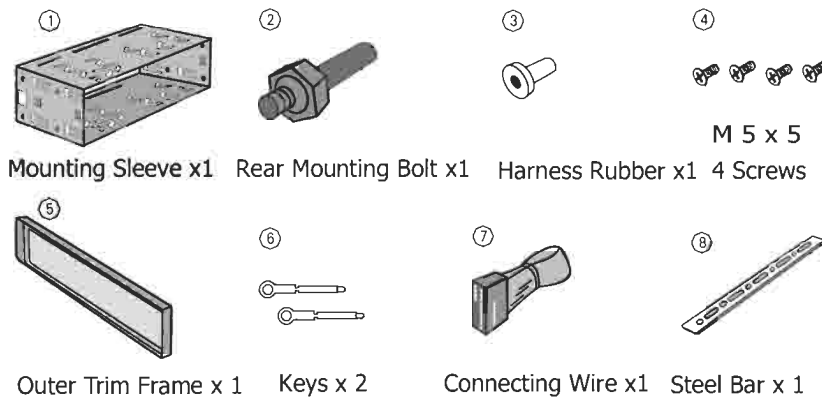

Cleaning the Connector

If the connector between the main unit and the front panel is dirty, it may result the unit in abnormal working condition. To avoid such problems happening, please detach the front panel, and clean the connector with an alcohol swab. Gently clean and avoid damaging the connector.

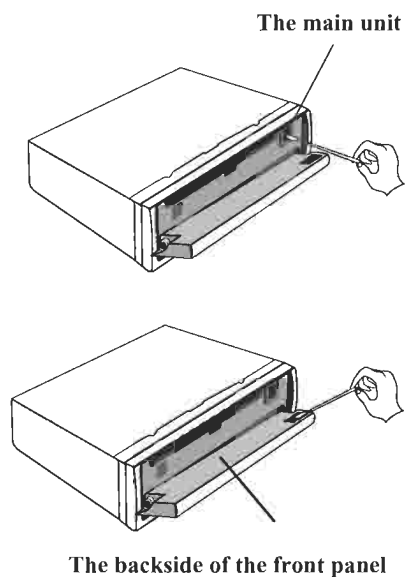

Notes:

- * For safekeeping, always shut down the generator and take out the key from the ignition before cleaning.
- Never keep your finger or any metal device touch the connector directly.

---Preferences page---

AUDIO SETUP

Example showing how to set audio output:

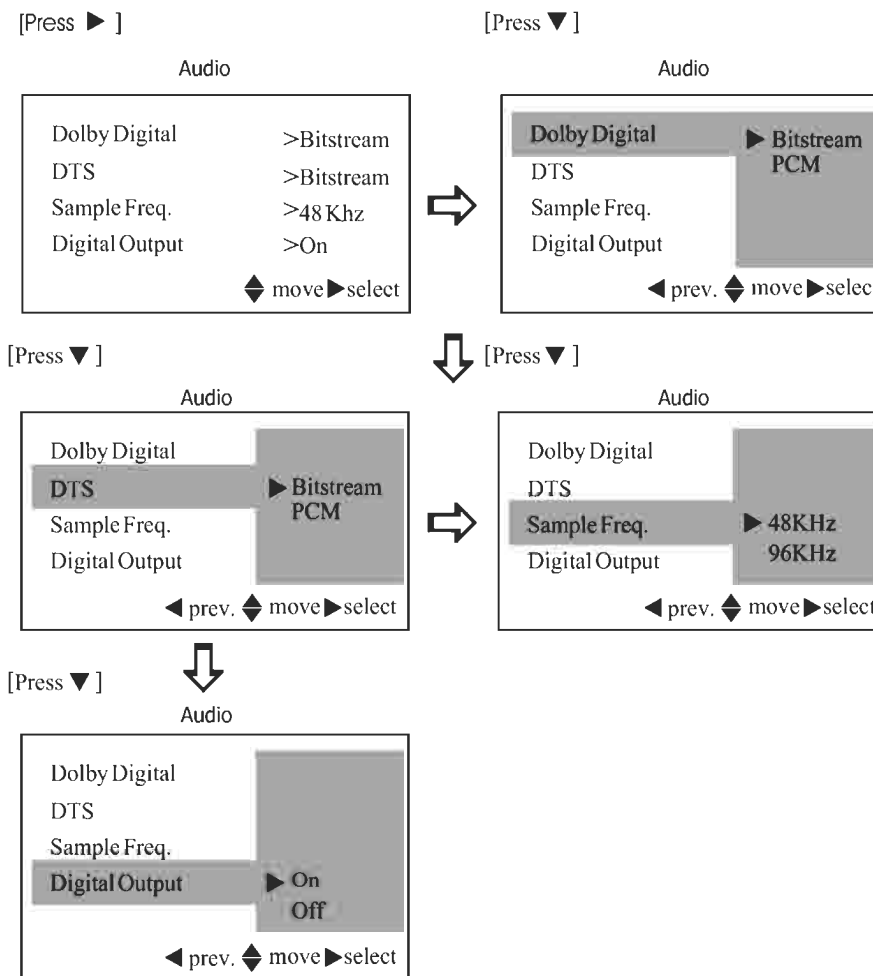

Note: The same operation with the language setup.

---Preferences page---

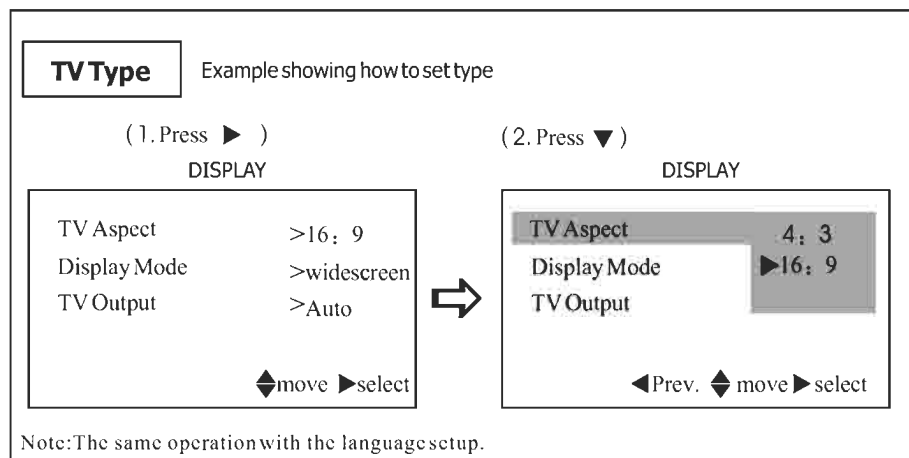

During TV Aspect is 4;3, you can setup Display Mode.

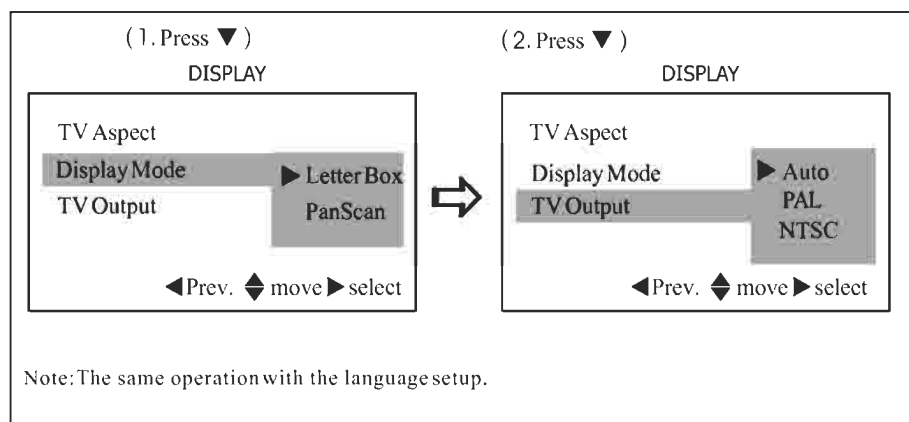
**The Starting Animation**

The animation appears when starting up. During operating a model, the animation appears at the lower level, and the operational information appears at the upper one. If there is no operation within 10 seconds, the LCD displays the animation automatically (no information appears).

Note:

* The animation do not display in ID3 mode.

Reset the Unit

Operating the unit for the first time or after replacing the car battery, you must reset the unit.

Remove the front panel at first, and then Press **⓫** **RESET** button on the base with a pointed object, (such as a ballpoint pen) to set the unit to initial status.

Note:

* When some errors occur on the display, you can also press **RESET** button to resume to normal, and it will erase the clock setting and some memorized functions.

* This function can only be operated by the head unit.

Turning the Unit On/Off

Press **⓫** **PWR** button to turn on the unit, press it again, the unit is still in the waiting status. When insert a disc, the unit will automatically start playing. Keep pressing it to turn off the unit completely.

Note:

* After the unit is off, the volume level is memorized during the area between 6 and 30. If the volume level is set less than 6, it will resume to 6; if it is higher than 30, it will resume to 30; if it is between 6 and 30, it still stores in the status which you set.

* Pressing **PWR** button on the head unit also performs the same operation.

Volume Control

Press **⓫** **VOL+** button to increase the sound level and press **⓫** **VOL-** button to decrease the sound level.

Note:

* Rotating(**VOL**) on the head unit also performs the same operation.

Setting the Sound Characteristics

Repeated briefly pressing **⓫** **SEL** button to select the desired mode in the following order:



- 1 After selecting the desired mode, you can adjust the current level by pressing **⓫** **VOL** buttons.
- 2 If you don't adjust **⓫** **VOL** buttons within 5 seconds after selecting the desired mode, the unit will automatically return to the current mode being displayed.
- 3 when **EQ** mode is activated, press **⓫** **SEL** button to select modes, **BAS**/**TREBLE** are invalid. (Shown as below)



Hold and press **SEL** to enter the BEEP mode, adjust this mode by **VOL** button.

If you don't adjust **⓫** **VOL** buttons within 5 seconds after selecting the desired mode, the unit will automatically return to the current mode being displayed.

Note:

* Pressing **SEL** button on the head unit to select mode.

* Rotating(**VOL**) on the head unit also performs the same operation.

Turning Loudness On/Off /My Best Position(MBP)

- Press **LOUD** button on the remote control to activate LOUD function. You can press this button to increase the low frequency, which can improve sensitivity for your ears. And “**LOUD**” appears. Press it again to shut down “**LOUD**” function.
- Press **MBP** button to activate MBP function. If there is no passenger in the car, you can perform MBP function and enjoy optimum sound.

LCD	F Speaker		R Speaker	
	L	R	L	R
MBP-A	0	-4dB	-4dB	-8dB
MBP-B	-4dB	0	-8dB	-4dB
MBP-OFF	0	0	0	0

Each time when you press and hold this button for 3 seconds, it will select the position as desired in the following order:



The corresponding mode will appear on the display.

If accurately adjusting the volume level needed, please use **SEL** button. (Refer to “*Setting the Sound Characteristics*” for more details)

Note:

- When activate BAL and FAD (“*Setting the Sound Characteristics*”), MBP mode will be turned off.
- Pressing LOUD/MBP on the head unit also performs the same operation.

EQ Setting

While listening to the popular music, classic music or rock music, you can select the corresponding preset modes to adjust the sound quality perfectly by using **EQ** button.

Repeatedly pressing **EQ** button to choose the following modes in turn:



Note:

- Bass mode and Treble mode return to initial settings when **EQ** system is on, “Bass” and “Treble” disappear.
- Keep pressing **EQ** button on the head unit also performs the same operation.

Displaying and Adjusting Time

Displaying Time: Press **DSP** button, and the current time is shown on the LCD, and it returns to original status after 3 seconds.

Adjusting Time: Press and hold **DSP** button until the two points in the middle of the clock stop blinking, you can rotate **VOL** button to adjust hours, press **DSP** the minutes blink, rotate **VOL** button to adjust minutes.

Note:

- press **DSP** and **VOL+/VOL-** on the remote control to perform the same function.
- After receiving a station, if the current time is not the same as the RDS's, the time of RDS will adjust to the current.

Mute Function

Press **MUTE** button to shut off the sound output. Press it again to resume to previous volume level.

Note:

- Pressing **MUT** on the head unit also performs the same operation.

Mode Selector

Press **SOURCE** button to select radio mode or playback mode.

Note:

- Pressing **MODE** on the head unit also performs the same operation.

Infrared Sensor:

Receptor on the head unit for the card remote commander.

AUX In (optional)

You can input the audio frequency into the main unit to increase the volume through **AUX**.

[Press **SETUP**, the screen will display system setting picture as follows:]

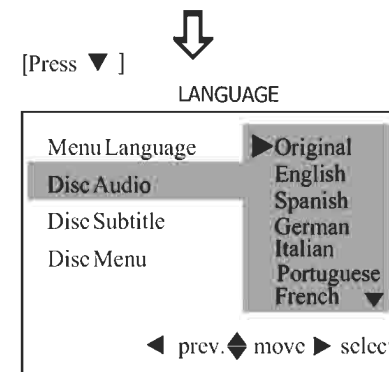
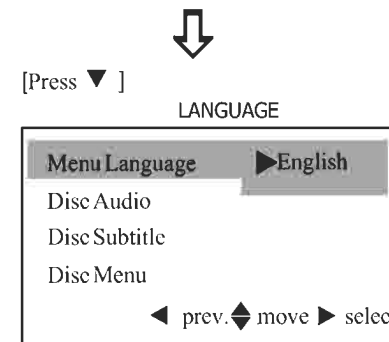
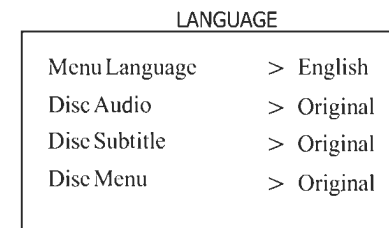

Note: The same operation with the language setup.

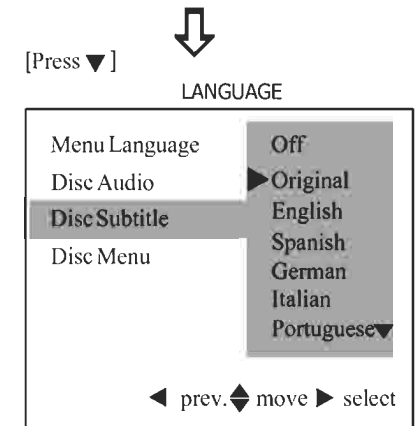

Note: The same operation with the language setup.

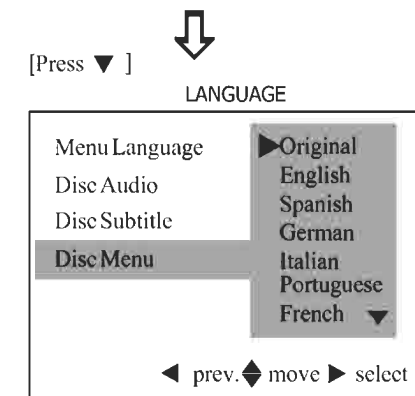

Note: The same operation with the language setup.

Preferences page:

[Press **SETUP**, the screen will display system setting picture as followings:]

LANGUAGE	
Menu Language	> English
Disc Audio	> Original
Disc Subtitle	> Original
Disc Menu	> Original

[Press **▶**]

DISPLAY	
TV Aspect	>16: 9
Display Mode	>widescreen
TV Output	>Auto

◆ move ▶ select

[Press **▶**]

AUDIO	
Dolby Digital	>Bitstream
DTS	>Bitstream
Sample Freq.	>48KHz
Digital Output	>On

◆ move ▶ select

[Press **▶**]

LOCKED	
Rating	>Unlock
Password	>****
Country Code	>US

◆ move ▶ select

[Press **▶**]

OTHERS	
Load Default	>Select
Screen Saver	>On

◆ move ▶ select

Basic operation of DVD

Insert a DVD disc into the slot, the unit will automatically switch on, if a DVD disc is loaded, press **2 SOURCE** on the remote control to start the playback.

Note:

* Pressing **▲** button on the head unit to eject a disc.

Playing the Previous/Next Track

During DVD playback, firstly pressing **6** **◀** to replay the current track, press **6** **▶** within 3 seconds to play the previous track, press **▶▶** to play the next track.

Note:

* Pressing **12** button on the head unit also performs the same operation.

Playing Track F.F/F.REW

Press **6** **▶▶** or **◀◀** to play the track fast forward or fast rewind: each pressing, the change is as following:

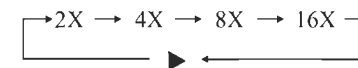
**Note:**

* Pressing **12** button on the head unit also performs the same operation.

Stop the playback

During DVD mode, firstly pressing **16** **■** to pause playing, press **6** **▶** or **9** **||** to play, press **■** button twice to stop playing completely, press **PLAY** button to start playing.

Note:

* This function is operated by using the remote control.

Slow motion playback

Press **8** **||** to slow forward or slow backward. There are 5 speeds each pressing decreases the speed until the minimum speed is reached.

**Note:**

* This function is operated by using the remote control.

System Button

During DVD playback, press **15** **P/N** button to select standard TV system: AUTO, NTSC, PAL.

Note:

* This function is operated by using the remote control.

Increase the size of the picture

Press **17** **ZOOM** to increase the picture in size. There are 2 sizes, Each pressing increases the size until the maximum size is reached.

X400% → X1600% → OFF

Note:

- * This function is operated by using the remote control.
- * Pressing **8** to remove the image on the screen.
- * press **22** **CLEAR** to decrease the large image.

Repeat Playing

press **1** **RPT** on the remote control to re-play the current track, press it again to cancel this function.

Note:

- * Pressing RPT on the head unit also performs the same operation.
- * The default setting is **DISC REPEAT**.

On-screen display

During DVD playback, press **7** **OSD**, the monitor shows: *total titles, total chapters, total elapsed time, remain time and the current chapter being played.*

Note:

- * This function is operated by using the remote control.

Setting the Playing Time

During DVD playback, press **27** **GOTO** to set the time, when the LCD display--:--:, input the numbers you want to set. For example, input **00:20:00**, the playing will be start playing from the 20 minutes point of the disc.

Note:

- * This function is operated by using the remote control.
- * Press **22** **CLEAR** to eradicate mistakes.



Changing the viewing angle (Multi-angle)

With DVDs featuring multi-angle (scenes shot from multiple angles) recordings, you can press **26** **ANGLE** to switch among viewing angles during playback.

Selection options switch as follows:

ANGLE 1 — **ANGLE 2** — **ANGLE 3**

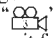
Note:

- * This function is operated by using the remote control.
- * This function only operates with DVDs featuring multi-angle recordings.
- * The “” mark on a DVD's package indicates it features multi-angle scenes. The number in the “” mark indicates the number of angles from which scenes were shot.
- * You cannot switch angles during slow motion playback.
- * If you press ANGLE during fast forward/fast reverse or pause, fast forward/fast reverse or pause is canceled and normal playback resumes but the viewing angle does not change.

Changing audio language (Multi-audio)

DVDs can provide audio playback with different language. With DVDs featuring multi-audio recordings, you can press **4** **AUDIO** to switch between language and audio systems during playback.

Selection options switch as follows:

AUDIO 1 — **AUDIO 2** — **AUDIO 3**

Note:

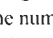
- * This function is operated by using the remote control.
- * This function only operates with DVDs featuring multi-audio recordings.
- * The number in the “” mark on a DVD's package indicates the number of recorded languages/audio systems.
- * During VCD mode, you can press **AUDIO** to select left channel, right channel or stereo channel.

Changing the subtitle language (Multi-subtitle)

With DVDs featuring multi-subtitle recordings. You can press **3** **SUB-T** to switch between subtitle languages during playback.

Selection options switch as follows:

Subtitles 1 — **Subtitles 2** — **Subtitles OFF**

Note:

- * This function is operated by using the remote control.
- * This function only operates with DVDs featuring multi-subtitle recordings.
- * The number in the “” mark on a DVD's package indicates the number of recorded subtitle languages.

Selecting Different Menu/Title

Under DVD playback mode, press **24** **MENU** or **25** **TITLE** to return to the root menu or the title menu, the monitor display all the chapters or all titles. You can press **6** and **5** **Number Buttons** on the remote control to select different chapter or title.

Note:

- * This function is operated by using the remote control.

Eject a Disc

Press **13** **▲** button to eject a disc.

Notes:

- * This function can only be operated by the head unit.

SET UP MENU

During DVD playback, press **18** **SET UP**, the screen will display system setting picture, the user can select some relative constant parameters. The user also can set it as needed by moving the cursor and using **6** [**▲**][**▼**][**◀**][**▶**] buttons, and then press **6** **ENTER** to execute the selecting or entering item.

Note:

- * This function is operated by using the remote control.
- * The selections are the preferred options that will be chosen if they are available on a disc. If the disc that is inserted does not have the preferred option then the discs own preference will be used.
- * Regarding SETUP MENU, please refer to the following pages for more details.
- * Some functions varies depending on the types of models or formats of the disc.